

Request for Proposals: Solar Array Operations & Maintenance Contract

The Champaign-Urbana Mass Transit District seeks proposals from qualified contractors to serve as operations and maintenance (O&M) provider for its solar arrays located in Urbana, Illinois. **Proposals must be submitted electronically to [procurement@mtd.org](mailto:procurement@mtd.org) by 3:00 PM Central Time on February 17, 2023.**

803 East University Avenue: 1,212-panel roof mounted solar array installed in 2013

1100 East University Avenue: 4,008 ground-mounted and 1,428 roof-mounted solar panels installed in 2022

Proposals must include:

- Cost proposal
- Schedule and description of O&M services proposed for each array
  - o For the roof array at 803 East University Avenue, include panel maintenance, inspection of roof membrane, and removal of debris from underneath solar array
- Response time guarantee
- Strategy for optimizing performance
- Relevant experience (both roof and ground mounted solar arrays)
- At least three customer references for previous similar work (include name and contact information)
- Identification of any subcontractors
- Proposal shall include an option for maintenance of meadow native grasses and wildflowers for the ground-mounted solar array as an option. Refer to drawing C-130 PLANTING PLAN for description of required maintenance.
  - o Maintain and establish meadow by watering, weeding, mowing, trimming, replanting, and performing other operations as required to establish a healthy, viable meadow.
  - o Roll, regrade, and replant bare or eroded areas and re-mulch. Provide materials and installation the same as those used in the original installation.
  - o Fill in as necessary soil subsidence that may occur because of settling or other processes.
  - o Replace materials and meadow damaged or lost in areas of subsidence.
  - o Apply treatments as required to keep meadow and soil free of pests and pathogens or disease.
  - o Use integrated pest management practices whenever possible to minimize the use of pesticides and reduce hazards.
  - o Promptly remove soil and debris created by planting and maintenance work from paved areas. Clean wheels of vehicles before leaving site to avoid tracking soil onto roads, walks, or other paved areas. Remove surplus soil and waste material, including excess subsoil, unsuitable soil, trash, and debris, and legally dispose of them off Owner's property.

The O&M contract term will be three years with an option to extend to five years.

Proposals will be evaluated based on the following criteria:

Criteria	Weight
O&M Plan	40%
Experience and References	40%
Cost	20%

For questions, contact: Ashlee McLaughlin, 217.384.8188, [amclaughlin@mtd.org](mailto:amclaughlin@mtd.org)

To schedule a site visit, contact:

Josh Berbaum, 217.841.8107, [jberbaum@mtd.org](mailto:jberbaum@mtd.org)

Dave Thornton, 217.417.6028, [dthornton@mtd.org](mailto:dthornton@mtd.org)

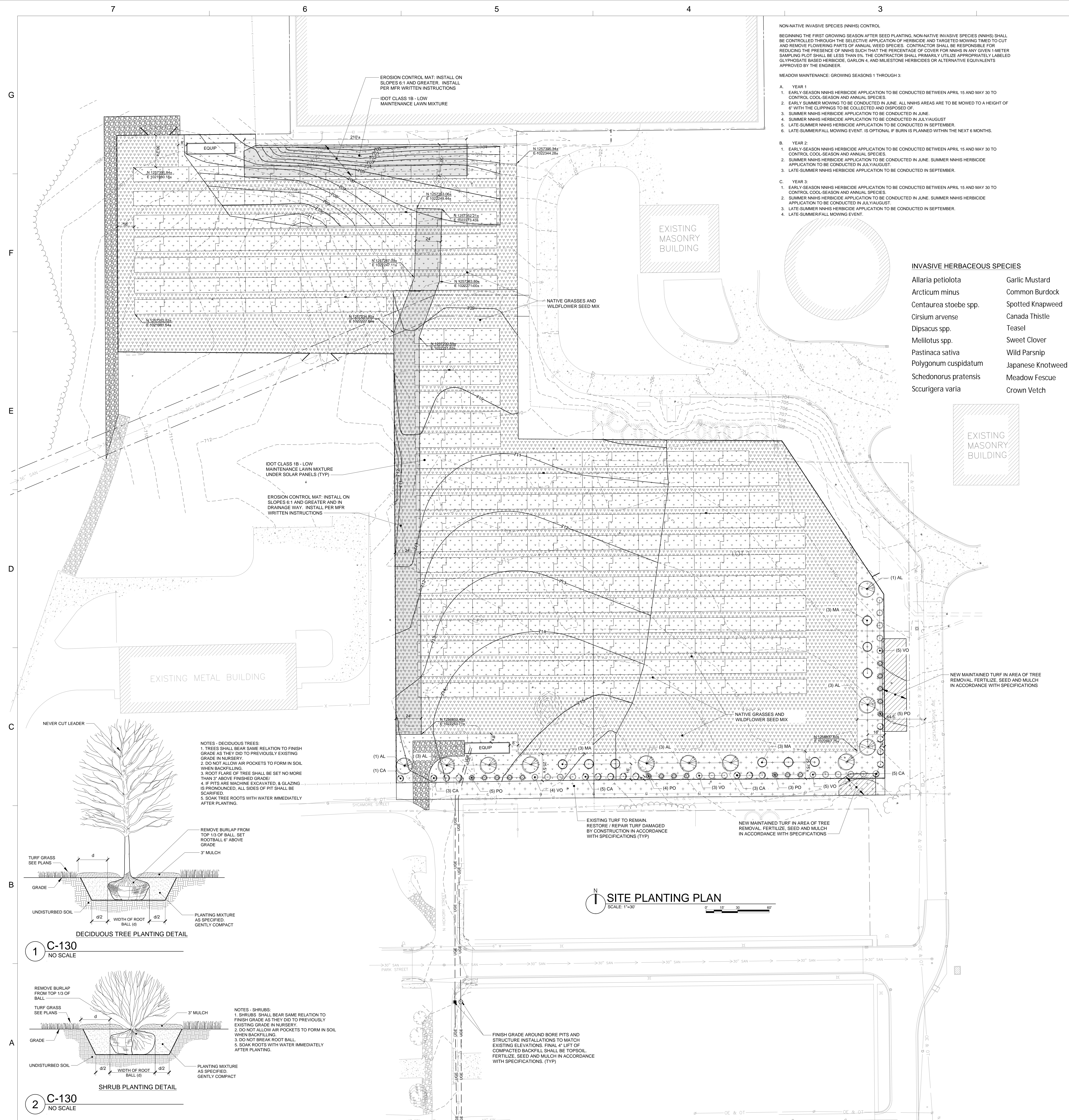

**NON NATIVE INVASIVE SPECIES (NNIS) CONTROL**

BEGINNING THE FIRST GROWING SEASON AFTER SEED PLANTING, NON-NATIVE INVASIVE SPECIES (NNIS) SHALL BE CONTROLLED THROUGH THE SELECTIVE APPLICATION OF HERBICIDE AND TARGETED MOWING TRIM TO CUT AND REMOVE FLOWERING PARTS OF ANNUAL WEED SPECIES. CONTRACTOR SHALL BE RESPONSIBLE FOR REDUCING THE PRESENCE OF NNIS SUCH THAT THE PERCENTAGE OF COVER FOR NNIS IN ANY GIVEN 1-METER SAMPLING PLOT SHALL BE LESS THAN 5%. THE CONTRACTOR SHALL PRIMARILY UTILIZE APPROPRIATELY LABELED GLYPHOSATE BASED HERBICIDE, GARLON 4, AND MILESTONE HERBICIDES OR ALTERNATIVE EQUIVALENTS APPROVED BY THE ENGINEER.

**MEADOW MAINTENANCE: GROWING SEASONS 1 THROUGH 3:**

**A. YEAR 1**

1. EARLY-SEASON NNIS HERBICIDE APPLICATION TO BE CONDUCTED BETWEEN APRIL 15 AND MAY 30 TO CONTROL COOL-SEASON AND ANNUAL SPECIES.
2. EARLY SUMMER MOWING TO BE CONDUCTED IN JUNE. ALL NNIS AREAS ARE TO BE MOWED TO A HEIGHT OF 4" WITH THE CLIPPINGS TO BE COLLECTED AND DISPOSED OF.
3. SUMMER NNIS HERBICIDE APPLICATION TO BE CONDUCTED IN JUNE.
4. SUMMER NNIS HERBICIDE APPLICATION TO BE CONDUCTED IN JULY/AUGUST.
5. LATE-SUMMER NNIS HERBICIDE APPLICATION TO BE CONDUCTED IN SEPTEMBER.
6. LATE-SUMMER/FALL MOWING EVENT. IS OPTIONAL IF BURN IS PLANNED WITHIN THE NEXT 6 MONTHS.

**B. YEAR 2:**

1. EARLY-SEASON NNIS HERBICIDE APPLICATION TO BE CONDUCTED BETWEEN APRIL 15 AND MAY 30 TO CONTROL COOL-SEASON AND ANNUAL SPECIES.
2. SUMMER NNIS HERBICIDE APPLICATION TO BE CONDUCTED IN JUNE. SUMMER NNIS HERBICIDE APPLICATION TO BE CONDUCTED IN JULY/AUGUST.
3. LATE-SUMMER NNIS HERBICIDE APPLICATION TO BE CONDUCTED IN SEPTEMBER.

**C. YEAR 3:**

1. EARLY-SEASON NNIS HERBICIDE APPLICATION TO BE CONDUCTED BETWEEN APRIL 15 AND MAY 30 TO CONTROL COOL-SEASON AND ANNUAL SPECIES.
2. SUMMER NNIS HERBICIDE APPLICATION TO BE CONDUCTED IN JUNE. SUMMER NNIS HERBICIDE APPLICATION TO BE CONDUCTED IN JULY/AUGUST.
3. LATE-SUMMER NNIS HERBICIDE APPLICATION TO BE CONDUCTED IN SEPTEMBER.
4. LATE-SUMMER/FALL MOWING EVENT.

- INVASIVE HERBACEOUS SPECIES**
- |                       |                   |
|-----------------------|-------------------|
| Allaria petiolata     | Garlic Mustard    |
| Arcticum minus        | Common Burdock    |
| Centaurea stoebe spp. | Spotted Knapweed  |
| Cirsium arvense       | Canada Thistle    |
| Dipsacus spp.         | Teasel            |
| Mellilot spp.         | Sweet Clover      |
| Pastinaca sativa      | Wild Parsnip      |
| Polygonum cuspidatum  | Japanese Knotweed |
| Schedonorus pratensis | Meadow Fescue     |
| Scourigera varia      | Crown Vetch       |

Dewberry Engineers, Inc.  
401 SW Water Street  
Suite 701  
Peoria IL 61602  
309.282.8000 Phone  
309.282.8001 Fax  
IL DESIGN FROM REG.  
#184005007-0006

CHAMPAIGN-URBANA MASS TRANSIT DISTRICT

CHAMPAIGN-URBANA MTD SOLAR ARRAY EXPANSION PHASE 1: UCSD

1100 E UNIVERSITY AVENUE,  
URBANA, IL

ISSUED FOR BID

FINISH GRADE AROUND BORE PITS AND STRUCTURE INSTALLATIONS TO MATCH EXISTING ELEVATIONS. FINAL 4" LIFT OF COMPACTED BACKFILL SHALL BE TOPSOIL. FERTILIZE, SEED AND MULCH IN ACCORDANCE WITH SPECIFICATIONS. (TYP)

**PARTIAL SITE PLN**  
SCALE: 1"=30'

**LEGEND**

- IDOT CLASS 1B LOW MAINTENANCE LAWN MIX
- NATIVE GRASSES AND WILDFLOWER SEED MIX
- EXISTING TURF TO REMAIN
- TREES
- SHRUBS
- AGGREGATE SERVICE DRIVE

**PLANTING NOTES**

1. ALL STOCKPILE AREAS SHALL BE LOCATED WITHIN LIMIT OF WORK LINE AND STABILIZED TO PREVENT EROSION.
2. ALL DEBRIS GENERATED DURING SITE PREPARATION ACTIVITIES SHALL BE LEGALLY DISPOSED OFF SITE.
3. PLANTING SEED SHALL BE SOWN IN SEASONAL CONDITIONS AS APPROPRIATE FOR GOOD SEED SURVIVAL OR AT SUCH TIMES AS APPROVED BY THE OWNER.
4. PROTECT NEWLY TOPSOILED, GRADED AND/OR SEEDED AREAS FROM TRAFFIC AND EROSION. KEEP AREAS FREE OF TRASH AND DEBRIS RESULTING FROM LANDSCAPE CONTRACTOR OPERATIONS.
5. REPAIR AND RE-ESTABLISH GRADES IN SETTLED, ERODED AND RUTTED AREAS TO THE SPECIFIED GRADE AND TOLERANCES.
6. ALL PLANT MATERIAL SHALL CONFORM TO THE MINIMUM GUIDELINES ESTABLISHED BY THE 'AMERICAN STANDARD FOR NURSERY STOCK' PUBLISHED BY THE AMERICAN NURSERY AND LANDSCAPE ASSOCIATION.
7. ANY PROPOSED SUBSTITUTIONS OF PLANT MATERIAL SHALL BE MADE WITH MATERIAL EQUIVALENT TO THE DESIRED MATERIAL IN OVERALL FORM, HEIGHT, BRANCHING HABIT, FLOWER, LEAF, COLOR, FRUIT AND CULTURE. PROPOSED SUBSTITUTIONS WILL ONLY BE CONSIDERED IF SUBMITTED WITH ENUMERATED REASONS WHY SUBSTITUTIONS ARE PROPOSED.
8. THE LANDSCAPE CONTRACTOR SHALL CLEAN UP AND REMOVE ANY DEBRIS FROM THE SITE CAUSED BY THE LANDSCAPE CONTRACTOR.

**BASIS OF DESIGN NATIVE GRASSES AND WILDFLOWER SEED MIXTURE (AREA = 2.4 ACRES)**

Common Name	Scientific Name	PLS oz/Acre	Seeds/oz	Seeds/SF
<b>Grasses:</b>				
Sideoats Grama	Bouteloua curtipendula	24.0	9375	5.17
Copper Shouldered Oval	Carex ticknelli			
Sedge		3.5	33422	2.69
June Grass	Koeleria macrantha	1.5	150000	5.17
Little Bluestem	Schizachyrium scoparium	64.0	4900	12.93
Prairie Dropseed	Sporobolus heterolepis	3.0	14000	0.93
	<b>TOTAL</b>	<b>96.0</b>		<b>26.91</b>
<b>Nurse Crop:</b>				
Seed Oats	Avena sativa			
	<b>TOTAL</b>	<b>400.0</b>	<b>8125</b>	<b>74.61</b>
		<b>400.0</b>		<b>74.61</b>
<b>Forbes:</b>				
Nodding Onion	Allium oenunum	6.0	7700	1.06
Wild Columbine	Aquilegia canadensis	1.0	25000	0.57
Common Milkweed	Asclepias syriaca	4.0	4000	0.37
Partridge Pea	Chamaecrista fasciculata	16.0	3800	1.40
Sand coreopsis	Coreopsis lanceolata	10.0	12500	2.87
Purple Prairie Clover	Dalea purpurea	6.0	20000	2.76
Rough Blazing Star	Liatris aspera	2.0	13000	0.60
Wild Lupine	Lupinus pernis v. occidentalis	2.0	1000	0.05
Horse Mint	Monarda punctata	1.5	94000	3.24
Hairy Beard Tongue	Penstemon hirsutus	1.5	125000	4.30
Old-Field Goldenrod	Solidago nemoralis	1.0	240000	5.51
Heath Aster	Symphotrichum ericoides	1.0	140000	3.21
Golden Alexanders	Zizia aurea	2.0	12000	0.55
	<b>TOTAL</b>	<b>54.0</b>		<b>26.48</b>
	<b>Total oz/acre</b>	<b>550.00</b>		
	<b>Total lbs/acre</b>	<b>34.375</b>	<b>Total Native Seeds/SF</b>	<b>53.39</b>

**PLANT SCHEDULE**

EVERGREEN TREES	KEY	QTY.	BOTANICAL NAME	COMMON NAME	SIZE	REMARKS
MA	9		Malus Adirondack	Adirondack Crabapple	1-1/2" cal.	B&B Height or Spread Well Formed
AL	11		Amelechier laevis	Alegheny Serviceberry	1-1/2" cal.	B&B Height or Spread Well Formed
<b>SHRUBS</b>						
KEY	QTY.	BOTANICAL NAME	COMMON NAME	SIZE	REMARKS	
CA	17	Clethra Antifolia 'Ruby Spice'	Ruby Spice Clethra	4 Ht.	B&B Height or Spread Well Formed	
PO	17	Physocarpus opulifolius	Common Nivea	4 Ht.	B&B Height or Spread Well Formed	
VO	17	Viburnum opulus var. americanum	American Cranberry-bush	4 Ht.	B&B Height or Spread Well Formed	

**DECIDUOUS TREE PLANTING DETAIL**

NOTES - DECIDUOUS TREES:

1. TREES SHALL BEAR SAME RELATION TO FINISH GRADE AS THEY DID TO PREVIOUSLY EXISTING GRADE IN NURSERY.
2. DO NOT ALLOW AIR POCKETS TO FORM IN SOIL WHEN BACKFILLING.
3. ROOT FLARE OF TREE SHALL BE SET NO MORE THAN 2" ABOVE FINISHED GRADE.
4. IF PITS ARE MACHINE EXCAVATED, & GLACING IS IRONOUNCED, ALL SIDES OF PIT SHALL BE SCARIFIED.
5. SOAK TREE ROOTS WITH WATER IMMEDIATELY AFTER PLANTING.

REMOVE BURLAP FROM TOP 1/3 OF BALL SET ROOTBALL 6" ABOVE GRADE

3" MULCH

PLANTING MIXTURE AS SPECIFIED. GENTLY COMPACT

**SHRUB PLANTING DETAIL**

NOTES - SHRUBS:

1. SHRUBS SHALL BEAR SAME RELATION TO FINISH GRADE AS THEY DID TO PREVIOUSLY EXISTING GRADE IN NURSERY.
2. DO NOT ALLOW AIR POCKETS TO FORM IN SOIL WHEN BACKFILLING.
3. DO NOT BREAK ROOT BALL.
5. SOAK ROOTS WITH WATER IMMEDIATELY AFTER PLANTING.

REMOVE BURLAP FROM TOP 1/3 OF BALL

3" MULCH

PLANTING MIXTURE AS SPECIFIED. GENTLY COMPACT

**1 C-130**  
NO SCALE

**2 C-130**  
NO SCALE

**SEAL**

CHAMPAIGN-URBANA MASS TRANSIT DISTRICT  
REGISTERED PROFESSIONAL ENGINEER  
NO. 051971  
EXPIRES 11/30/2021

**REVISIONS**

No.	Description	Date

DRAWN BY: MKH  
APPROVED BY: MPB  
CHECKED BY: MPB  
DATE: 01/11/2021

**TITLE**

**SITE PLANTING PLAN AND DETAILS**

PROJECT NO. 50125690

**C-130**

SHEET NO.